

Bull's-Eye See Thru Flanged

Engineering Information:

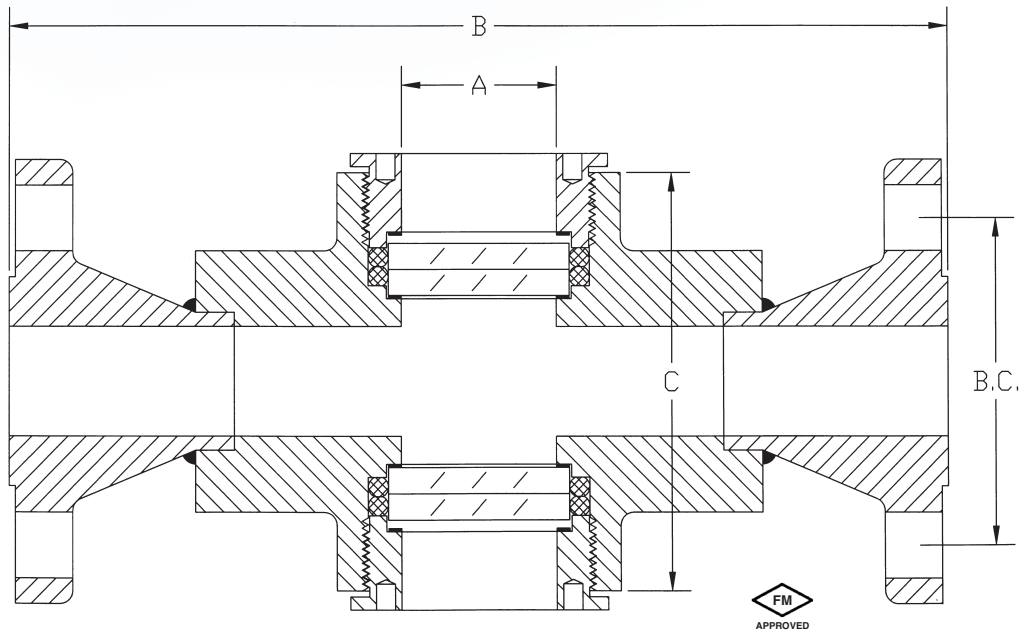

Size in ch - psi	A	B	C	B.C.	No. of Bolt Holes	Diam. of Bolt Holes
1/2-150	3/4	6 3/4	3 3/8	2 3/8	4	5/8
1/2-300	3/4	7 1/8	3 3/8	2 5/8	4	5/8
1/2-600	3/4	7 1/8	3 3/8	2 5/8	4	5/8
3/4-150	3/4	7 1/8	3 1/2	2 3/4	4	5/8
3/4-300	3/4	7 1/2	3 1/2	3 1/4	4	3/4
3/4-600	3/4	7 1/2	3 1/2	3 1/4	4	3/4
1-150	1 1/2	9 1/8	4	3 1/8	4	5/8
1-300	1 1/2	9 5/8	4	3 1/2	4	3/4
1-600	1 1/2	9 5/8	4	3 1/2	4	3/4
1 1/4-150	1 1/2	9 1/4	4 3/8	3 1/2	4	5/8
1 1/4-300	1 1/2	9 7/8	4 3/8	3 7/8	4	3/4
1 1/4-600	1 1/2	10	4 3/8	3 7/8	4	3/4
1 1/2-150	1 1/2	9 5/8	4 5/8	3 7/8	4	5/8
1 1/2-300	1 1/2	10 1/8	4 5/8	4 1/2	4	7/8
1 1/2-600	1 1/2	10 1/4	4 5/8	4 1/2	4	7/8

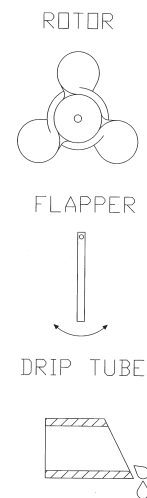

- Applications requiring DIN standards or non-ANSI flanges are available upon request.