

Model B Safesite

Engineering Information:

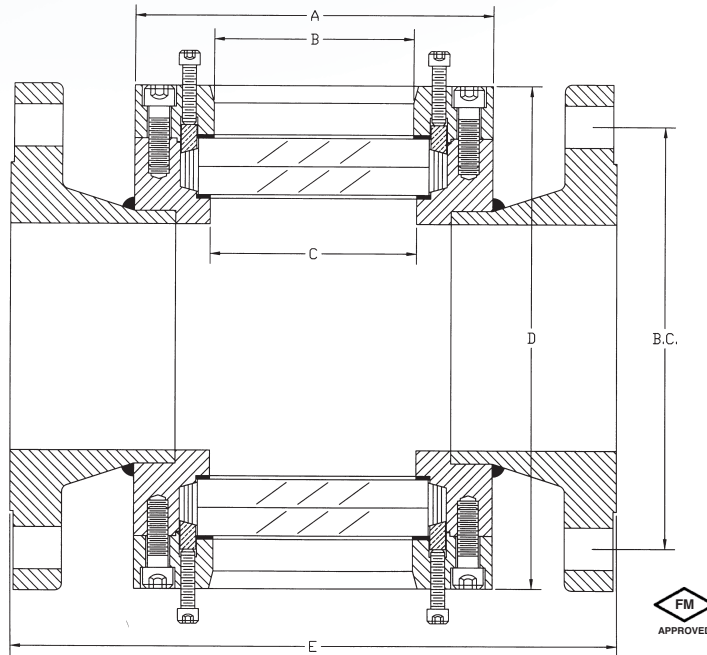

Size inch-psi	A	B	C	D	E	B.C.	No. of Bolt Holes	Diam. of Bolt Holes
2-150	4 1/2	1 3/4	1 15/16	7 1/4	8 7/8	4 3/4	4	3/4
2-300	4 3/4	1 3/4	1 15/16	7 1/4	9 5/8	5	8	3/4
3-150	5 1/2	2 5/8	2 7/8	8 3/8	9 3/4	6	4	3/4
3-300	5 3/4	2 5/8	2 7/8	8 7/8	10 7/8	6 5/8	8	7/8
4-150	6 1/2	3 5/8	3 3/4	9 3/8	10 3/4	7 1/2	8	3/4
4-300	7	3 5/8	3 3/4	9 7/8	12 1/8	7 7/8	8	7/8
6-150	9	5 1/2	5 3/4	12 5/8	13 1/8	9 1/2	8	7/8
6-300	9 1/4	5 1/2	5 3/4	13 7/8	14 1/4	10 5/8	12	7/8
8-150	11 3/4	7 3/8	7 11/16	15 5/8	16	11 3/4	8	7/8
8-300	11 3/4	7 3/8	7 11/16	16 3/8	16 3/4	13	12	1

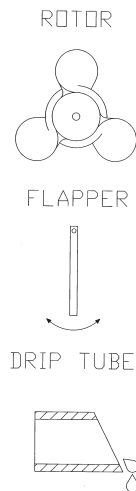

- This unit can also be furnished with any ANSI B16.5 flange, butt weld, or threaded connections, sanitary, as well as "T" and 90-degree angle flows.
- Applications requiring DIN standards or non-ANSI flanges are available upon request.
- Drip Tubes, Rotors, or Flappers are available on all inline units.